

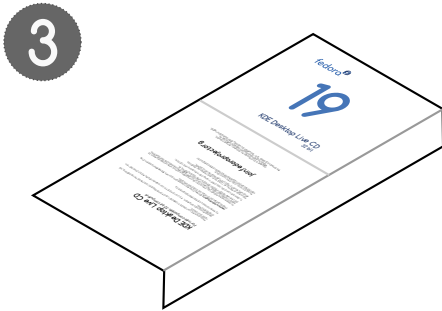

Print out the sleeve



Fold the left hand flap underneath



Fold the right hand flap underneath

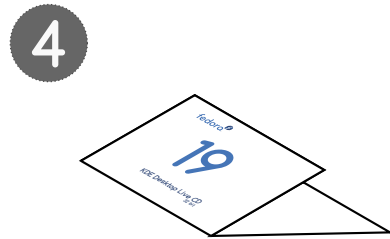

Fold the back cover underneath

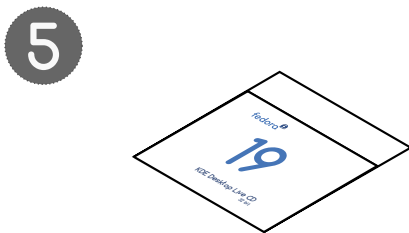

The cover should look like this.

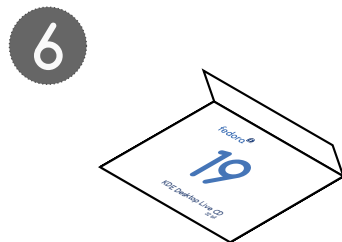

fold the top flap over the top of the front cover

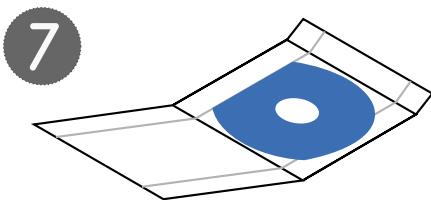

open the sleeve up, and place the disc under just the left side flap

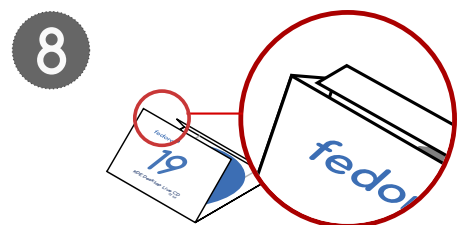

Fold the sleeve back together, inserting the entire top flap into the side flaps of the front cover

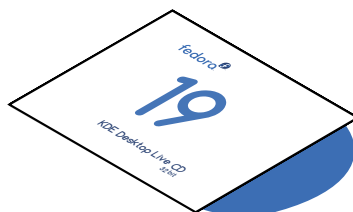

finished sleeve